

# CONFERENCE ROOMS AND MEETING FACILITIES



OCEAN REEF CLUB®

A UNIQUE WAY OF LIFE

KEY LARGO, FLORIDA

## OCEAN REEF CENTRAL MAP

1. Town Hall
2. Carysfort Hall
3. Key Largo Building
4. Ocean Reef Yacht Club Room
5. Marlin
6. Dolphin
7. Amberjack
8. Yachtsman
9. The Inn Lobby & Reef Lounge
10. Ocean Room
11. The Islander
12. Palm Court
13. Lagoon Beach
14. Mic's Beach
15. The Point
16. Marina Fitness Center
17. Town Hall Waterside
18. Marlin Beach
19. Amberjack Lawn



## CONFERENCE ROOMS AND MEETING FACILITIES

Facility	Dimensions	Square Feet	Ceiling Height	Classroom Style	Theatre	U-shape	Hollow Square	Conference Style	Banquet Style	Reception	
<b>TOWN HALL</b>											
Ballroom	70'x105'	7,350	15' – 17'	450	600	120	144	100	500	700	
Ballroom North	70'x52'	3,640	15' – 17'	225	300	60	88	50	240	350	
Ballroom South	70'x52'	3,640	15' – 17'	225	300	60	88	50	240	350	
Pre Function	24'x105'	2,520	15' – 17'						120	300	
Covered Patio	18'x120'	2,160	12'						120	200	
Lawn	30'x120'	3,600							200	600	
<b>CARYSFORT HALL</b>											
Carysfort Ballroom	72'x79'	5,688	15'	250	450	103	134	134	375	500	
Pelican	54'x72'	3,888	15'	170	310	79	110	110	250	350	
Pelican East	36'x54'	1,944	15'	85	150	61	74	74	120	200	
Pelican West	36'x54'	1,944	15'	90	160	62	76	76	120	200	
Everglades	25'x71'	1,775	15'	75	140	73	84	84	115	250	
Egret	23'x25'	575	15'	27	50	32	42	42	40	60	
Osprey	23'x25'	575	15'	25	45	32	42	42	30	50	
Heron	25'x25'	625	15'	25	45	33	44	44	30	50	
Carysfort Foyer	48'x30'	1,440	15'							200	
Lobby	30'x55'	1,650									
Tarpon/Carysfort Kitchen	37'x84'	3,108	13'	140	250	71	86	86	200	300	
Tarpon	37'x48'	1,776	13'	80	140	55	70	70	110	150	
Carysfort Kitchen	36'x37'	1,332	13'	60	115	31	46	46	90	120	
Sailfish	36'x43'	1,548	13'	65	120	48	64	64	100	150	
Permit*	24'x30'	720	11'	20	20	20	20	20	20	20	
Bonefish	23'x24'	552	12'	30	55	32	40	40	40	50	
Office	12'x18'	216	11'								
<b>KEY LARGO BUILDING</b>											
Poinciana Room	25'x50'	1,250	9.5'	54	90	45	54	54	80	125	
Frangipani Room	25'x50'	1,250	9.5'	54	90	45	54	54	80	125	
Hibiscus Room	25'x50'	1,250	9.5'	54	90	45	54	54	80	125	
<b>OCEAN ROOM</b>											
Reef Lounge	93'x50'	4,650	12'-13'	100	150	48	54	54	210	300	
	35'x55'	1,925	(floorplan not shown)								75
<b>OCEAN REEF</b>											
YACHT CLUB ROOM	33'x17.5'	578	8'	30	50	23	28	28		28	
<b>BUCCANEER ISLAND</b>											
Pool Deck & Lagoon Beach	The spacious areas on Buccaneer Island can adequately provide seating for up to 400 people. In addition, several semi-private areas including Palm Court and the Lagoon/Beach lend themselves to customized theme parties.										

\*Permanent board table with ergonomic chairs.

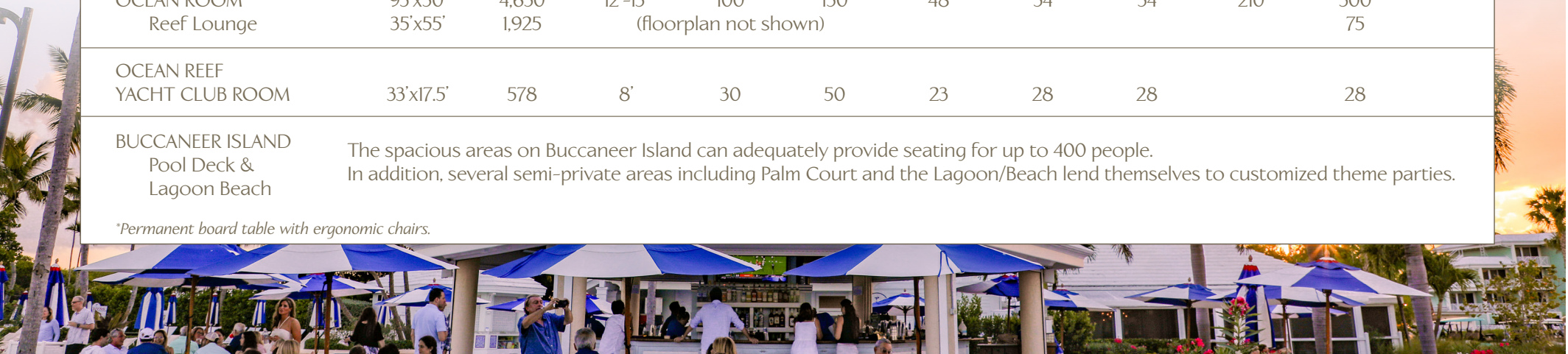

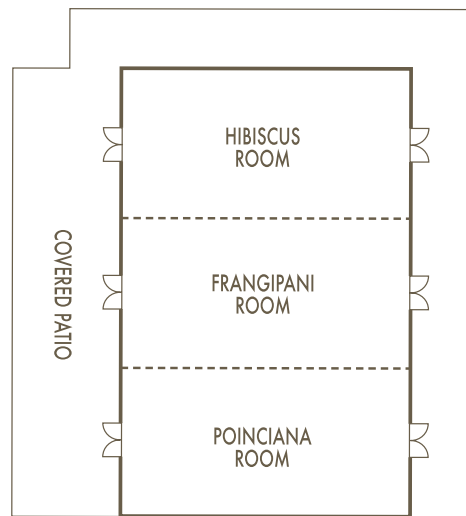
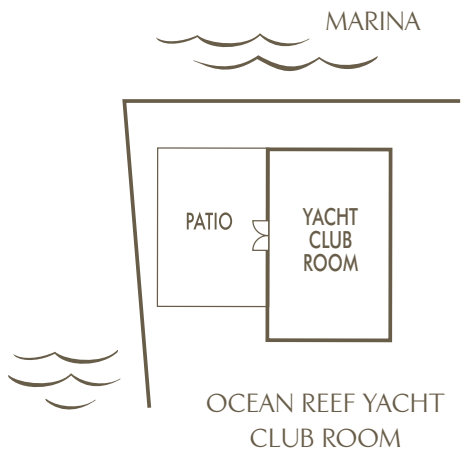

KEY LARGO BUILDING

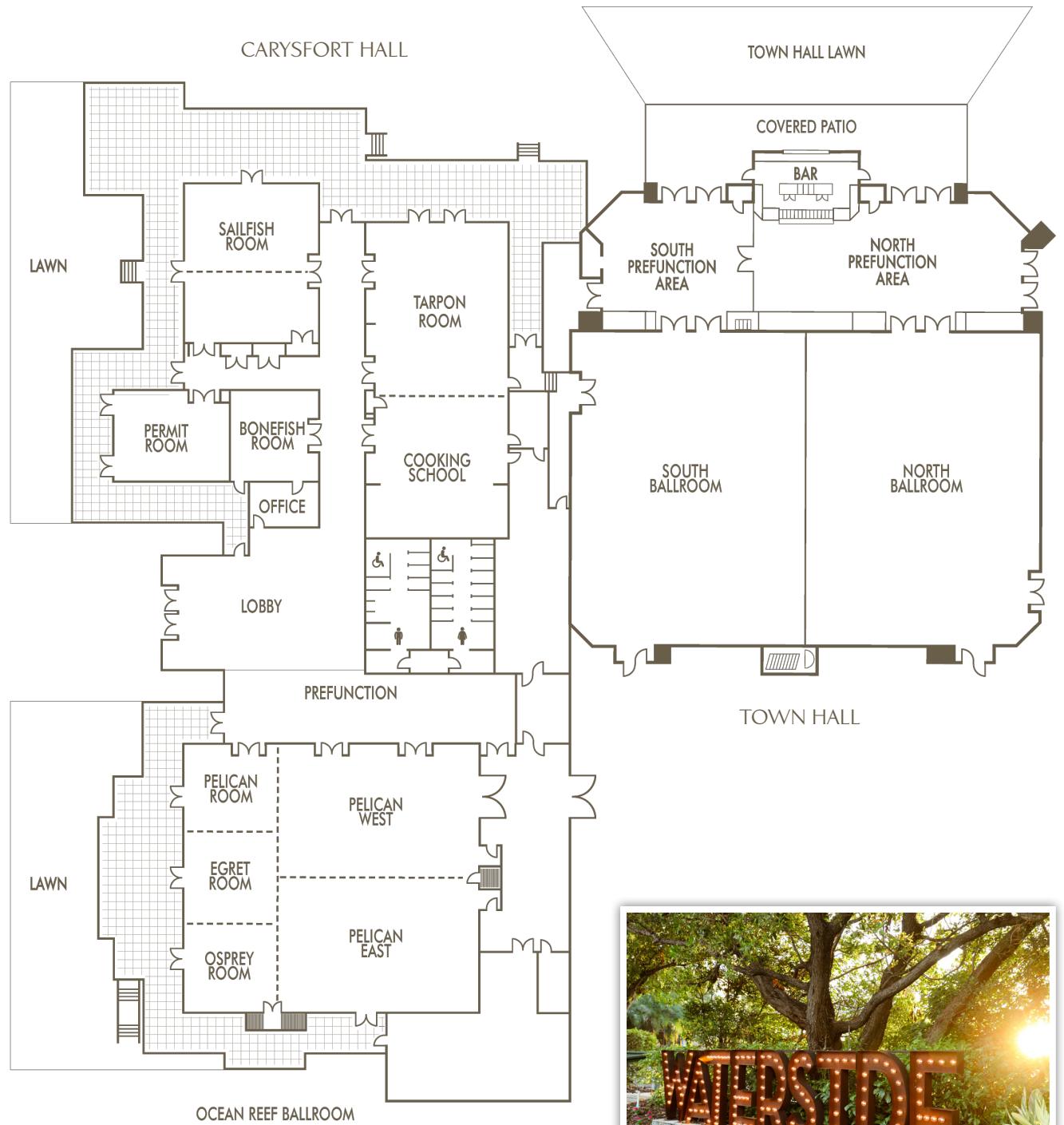





OCEAN REEF CLUB®

A UNIQUE WAY OF LIFE

KEY LARGO, FLORIDA

305-367-2611 • [OceanReef.com](http://OceanReef.com)  
35 Ocean Reef Drive, Suite 200 • Key Largo, Florida 33037